

est 1979

Jeremy
Leaf & Co.



Glowhill Court, Flat 1, 19 Granville Road, London, N12 0HH

£535,000

- Bathroom
- Council Tax Band E
- Recently Refurbished
- Garage and Off-Street Parking
- Share of Freehold
- Two Bedrooms
- Kitchen
- Service Charge £1,400 pa
- 0.5 Miles to Tube Station
- Reception

863 High Road, London, N12 8PT
020 8446 4295

property@jeremyleaf.co.uk
<https://www.jeremyleaf.co.uk/>

Flat 1, 19 Granville Road, London N12 0HH

A spacious and recently refurbished two-bedroom ground floor flat situated within a well-maintained purpose-built block. The property benefits from a private garage and an off-street parking space. Ideally located close to Ballards Lane's array of shops, cafes, and transport amenities, the flat is just 0.5 miles from West Finchley tube station. Sold with share of freehold - 950 (approx) year lease. Council Tax Band E.

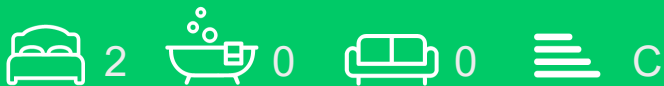

Council Tax Band: D



Full Description

A spacious and recently refurbished two-bedroom ground floor flat situated within a well-maintained purpose-built block. The property benefits from a private garage and an off-street parking space. Ideally located close to Ballards Lane's array of shops, cafes, and transport amenities, the flat is just 0.5 miles from West Finchley tube station. Sold with share of freehold. Council Tax Band E.

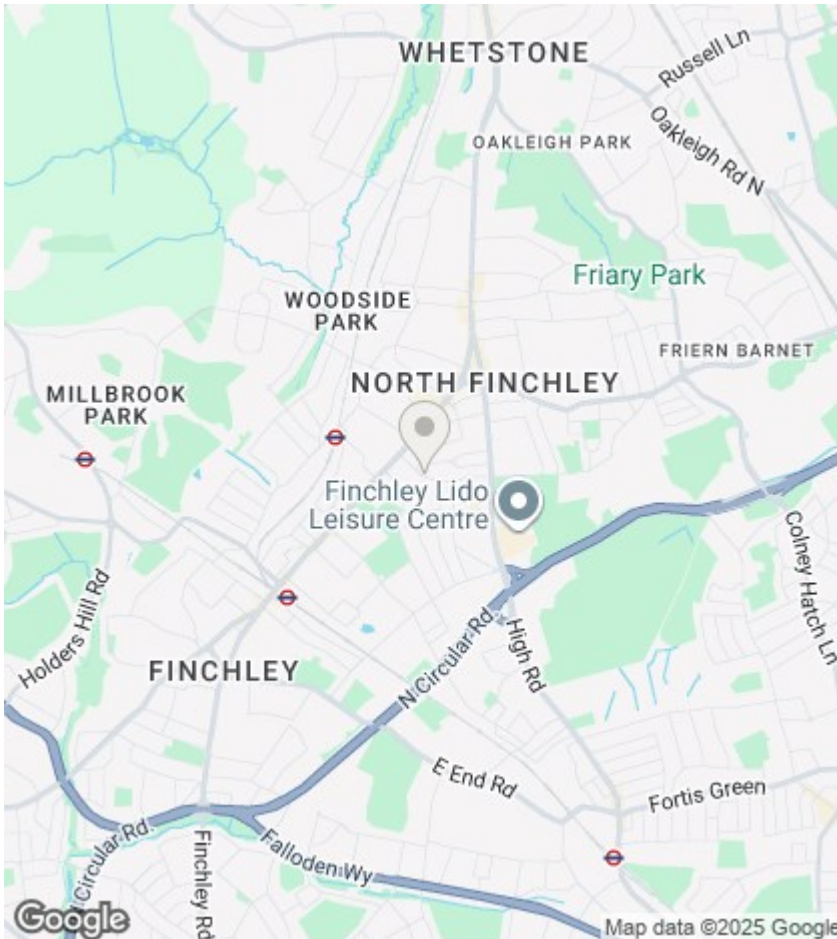

Directions

Viewings

Viewings by arrangement only. Call 020 8446 4295 to make an appointment.

EPC Rating:

C

Energy Efficiency Rating		
	Current	Potential
Very energy efficient - lower running costs		
(92 plus) A		
(81-91) B		
(69-80) C	72	75
(55-68) D		
(39-54) E		
(21-38) F		
(1-20) G		
Not energy efficient - higher running costs		
England & Wales	EU Directive 2002/91/EC	

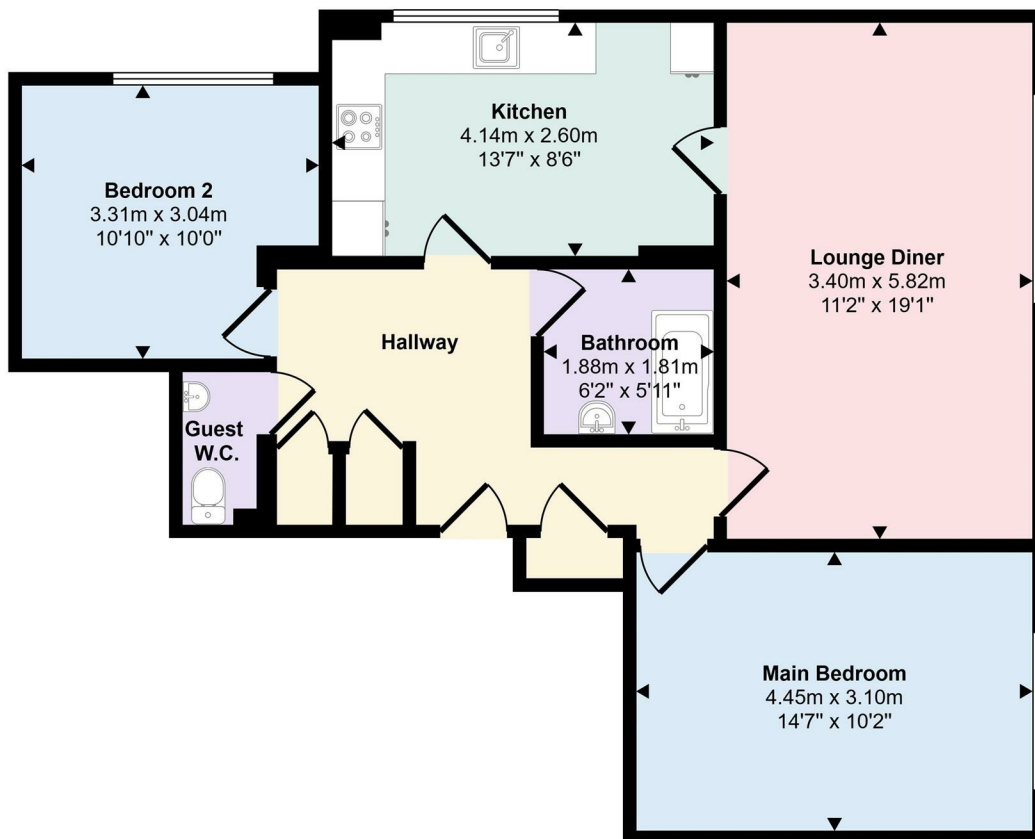

Floorplan